

规格说明:Specifications:

电气特性:Electrical:

1. 额定电流: Current Rating
3.0A/contact terminal
2. 额定电压: Voltage Rating
30V DC
3. 接触阻抗:Contact Resistance
30 milliohms MAX
4. 耐电压:Dielectnic Withstanding Voitage:
500 V AC AT Sea Level
5. 绝缘阻抗:Lnsulation Resistance:
1000MEGA ohms MIN

物理性能:Mechanical:

1. 插拔力: Cnnector Mate and Unmate Force
Mate force:3.57kgf (MAX)
Unmate force:1.02kgf (MIN)
2. 端子保持力: Terminal Retenion
1.2kgf (MIN)

原材料:Material:

1. 塑胶:Housing:
Hing Temperature Tnermaplastics,
U1 94V-0 PBT White/Black
2. 端子>Contact:Copper Alloy C2680
3. 外壳:Shell: C2680/SPCC

电镀:Finish:

1. 端子>Contact: Plated Gold in Mating Area;
Tin On Solder Talls
2. 外壳:Shell:
Nickel Plating

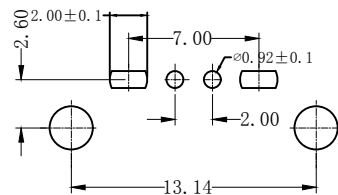
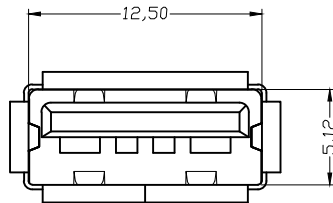
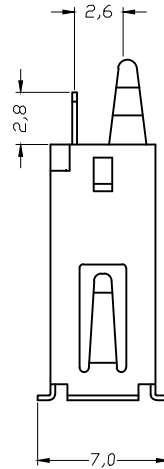
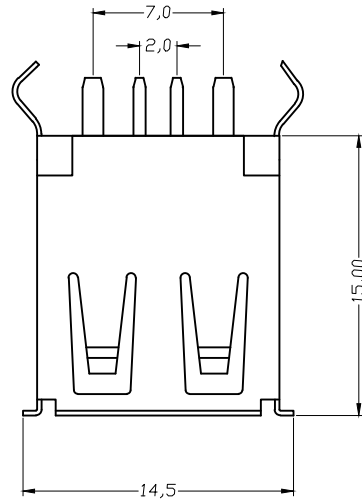

P.C.B LAYOUT
BOTTOM VIEW

WFD 深圳市旺富达电子有限公司 CONN SHEN ZHEN WFD ELECTRONICS CO., LTD		图号 (DWG NO)	UM-025	单位(UNIT): MM
		版本 (REV)	A/0	比例(SCALE) 1:1
品名 (ITEM NO)	A/F 直插卷边弯脚大电流L=15.0	日期 (DATE)	2012. 06. 08	未注公差 TOLERANCE UNSPECIFIED X.X ±0.30 X.XX ±0.20 X.XXX ±0.10 X° ±5° X.X° ±2°
料号 (PART NO)	USB-F2004-SC005	设计 (DESIGN)	Liu Miao	
模号 (MODEL NO)	WFD-026	审核 (CHECKED)	SIMON	
		核准 (APPROVED)	DAVID	