

REV.	DESCRIPTION	DRAW.	DATE.

A
B
C
D
E

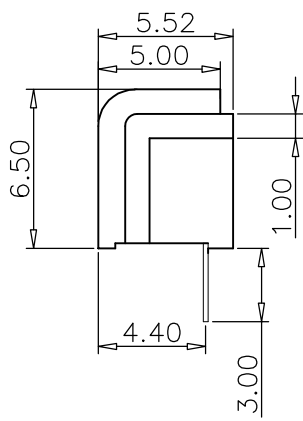
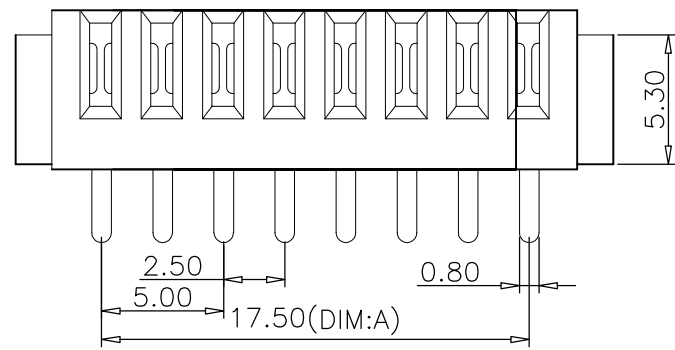
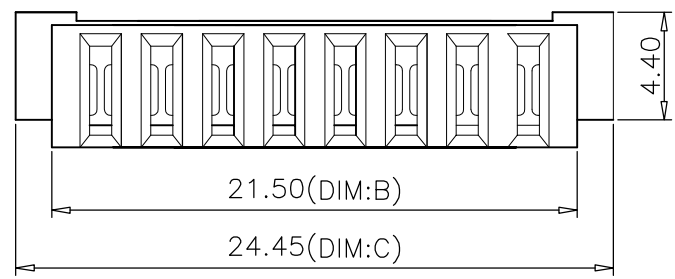

No:of pins	Dimension		
	DIM.A	DIM.B	DIM.C
03	5.00	9.00	12.95
04	7.50	11.50	14.45
05	10.00	14.00	16.95
06	12.50	16.50	19.45
07	15.00	19.00	21.95
08	17.50	21.50	24.45
09	20.00	24.00	26.95
10	22.50	26.50	29.45

Material
 Insulator:Nylon 9T(UL94V-0)
 Contact:phosphor Bronze
 Contact Plated:Gold over Nickel or Tin
 Specification
 Current rating:5A
 instant CURRENT:7A
 Contact Resistance:30MΩ
 Insulation Resistance:100MΩ
 Dielectric Voltage:500V
 Operdting Temperature:-40°~105°

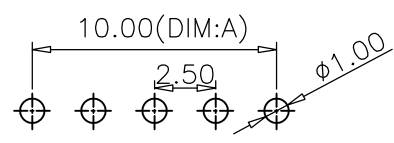

Recommended P.C.B Layout
 Layout Tolerance=+/-0.05mm

WFD 深圳市旺富达电子有限公司
 SHEN ZHEN WFD ELECTRONICS CO., LTD

DESIGN	LIU MIAO	DATE	2016.04.08	TITLE:	Battery 180° 2.5PH母座
APPROVED		DATE			
PART NO	MPB-AF025-KXX	REV:	01	SCALE: 1:1	UNIT: mm
DRAWING NO		SIZE:	A4	SHEET: 1/1	

UNLESS OTHERWISE SPECIFIED, TOLERANCE:	
X.	±0.20
X.x	±0.15
X.xx	±0.10
ANGULAR	±2°