

REVISION RECORD				
REV	ECN	DESCRIPTION	DRFT	DATE
A		更新深圳旧图纸		

NOTES1:
 UL Standard
 1.Rated voltage/current : 600V / 25A
 2.Withstanding voltage : AC2000V/1Min.

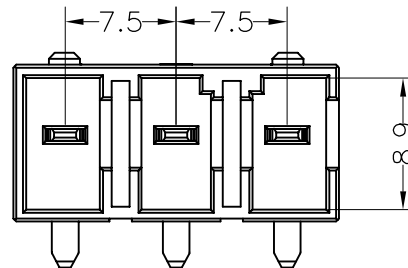

IEC Standard

1. Pollution degree	2
Overvoltage category	III
Rate impulse voltage(KV)	4KV
Rate voltage(V)	400V
Rate current(A)	32A

NOTES2:
 1.Dimension shall be interpreted per ASME Y14.5-2009
 2.Pitch : 7.5mm, Poles : N=02~24P
 3.Operating temperature:-40°C~+105°C
 4.Undimensioned tolerances:

Pitch range in mm		Nominal dimension range in mm						—	∩	∇
TO	Over	Over	TO	Over	Over	Over	TO	Over	Over	
6	6	10	30	30	60	100	30	60	150	
±0.15	±0.20	±0.30	±0.30	±0.50	±0.70	±1.00	±1.30	±2'		

5.RoHS Compliance

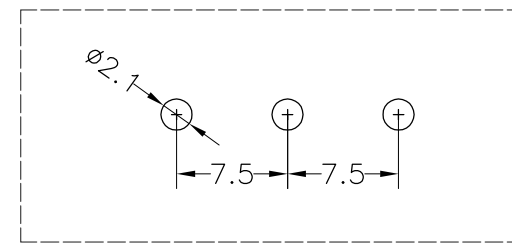
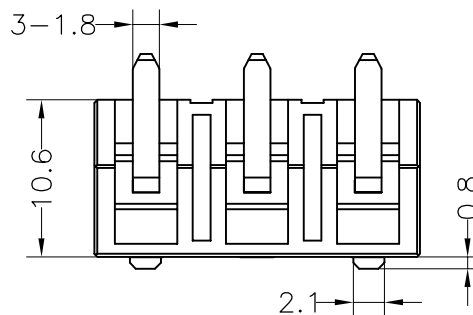
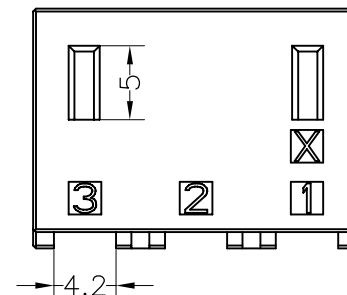
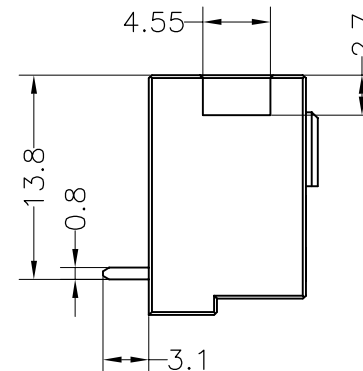
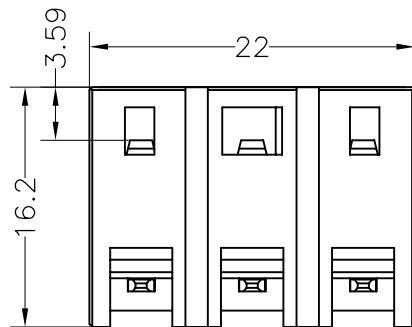
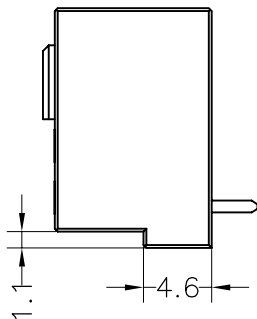

PCB LAYOUT

Ordering Information

WFD8EDGKHRC - 750 03 B 01

Pitch
750=7.5PH

No.of pins
2P~12P

Housing Color
 B=Black
 G=Green
 U=Blue
 R=Red
 W=White
 Y=Yellow
 O=Orange
 E=Grey

Packing
 O=Pe bag
 T=Tube
 A=Tray

DRAW	LIU MIAO	SCALE	FIT	WFD 深圳市旺富达电子有限公司 CONN SHEN ZHEN WFD ELECTRONICS CO., LTD	
		UNIT	mm		
CHECK		SIZE	A4	PART NO.	WFD8EDGKHRC-75003B01
		SHEET	1/1	TITLE:	7.5-3P端子台/90度/黑色/新光 PBT/半金锡2u'/第3P右开口
APPROVE		PROJ.			