

版次(Ed')	变更摘要(Change The Content)	日期(Date)	序号 No.	品名Name	材质Material
0	增加料号说明(Add Material Number Description)	2020/11/23	①	0.5拉拔3代胶芯(H2.0) 0.5 Pitch ZIF Type 3 Housing (H=2.0)	LCP UL94V-0 本色 <b>Natural</b>
			②	0.5拉拔上接端子(H2.0) 0.5 Pitch H2.0 ZIF R/A Type Upper terminal	磷青铜/表面镀锡 Phosphor Bronze/ Tin Plating
			③	0.5拉拔3代后盖(H2.0) 0.5 Pitch ZIF Type 3 Actuator (H=2.0)	LCP UL94V-0 黑色 <b>Black</b>
			④	0.5拉拔3代焊片(H2.0) 0.5 Pitch ZIF Type 3 Fitting Nail (H=2.0)	黄铜/表面镀锡 Brass/Tin Plating

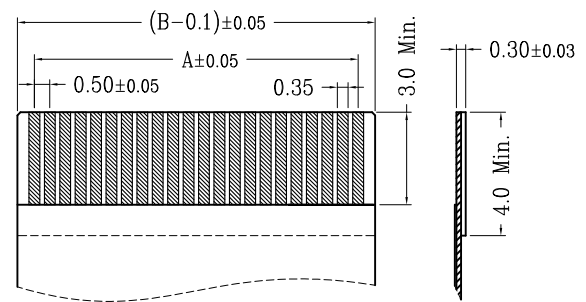
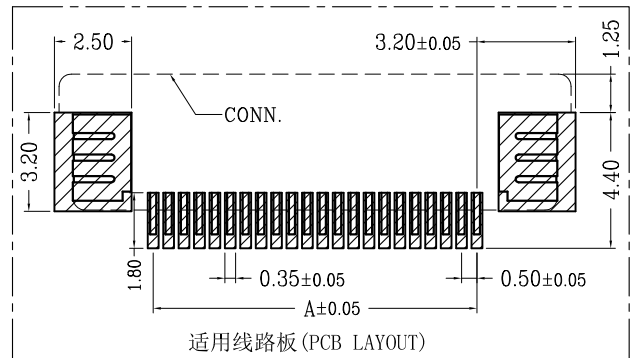
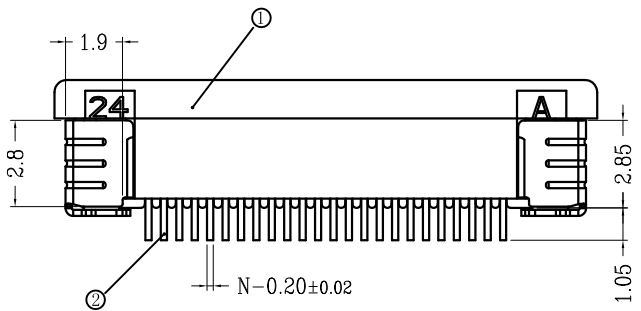
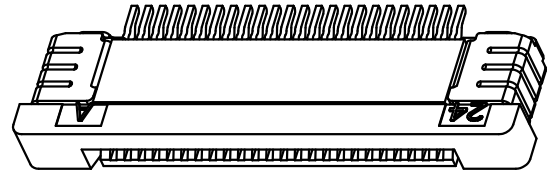
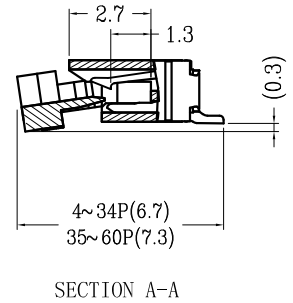
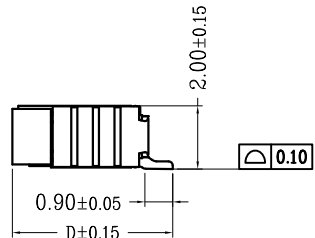
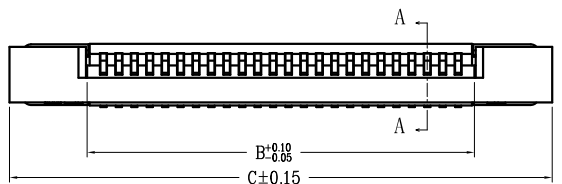
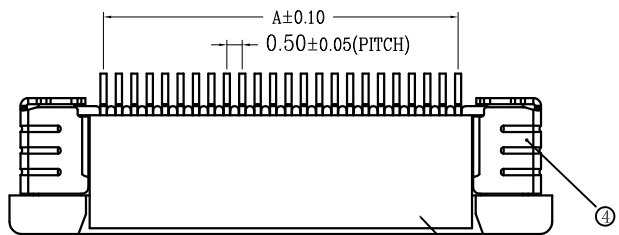

CKT	A	B	C	D	CKT	A	B	C	D
4	1.50	2.56	7.6		33	16.00	17.06	22.1	5.2
5	2.00	3.06	8.1		34	16.50	17.56	22.6	
6	2.50	3.56	8.6		35	17.00	18.06	23.1	
7	3.00	4.06	9.1		36	17.50	18.56	23.6	
8	3.50	4.56	9.6		37	18.00	19.06	24.1	
9	4.00	5.06	10.1		38	18.50	19.56	24.6	
10	4.50	5.56	10.6		39	19.00	20.06	25.1	
11	5.00	6.06	11.1		40	19.50	20.56	25.6	
12	5.50	6.56	11.6		41	20.00	21.06	26.1	
13	6.00	7.06	12.1		42	20.50	21.56	26.6	
14	6.50	7.56	12.6		43	21.00	22.06	27.1	
15	7.00	8.06	13.1		44	21.50	22.56	27.6	
16	7.50	8.56	13.6		45	22.00	23.06	28.1	
17	8.00	9.06	14.1		46	22.50	23.56	28.6	
18	8.50	9.56	14.6	5.2	47	23.00	24.06	29.1	
19	9.00	10.06	15.1		48	23.50	24.56	29.6	5.8
20	9.50	10.56	15.6		49	24.00	25.06	30.1	
21	10.00	11.06	16.1		50	24.50	25.56	30.6	
22	10.50	11.56	16.6		51	25.00	26.06	31.1	
23	11.00	12.06	17.1		52	25.50	26.56	31.6	
24	11.50	12.56	17.6		53	26.00	27.06	32.1	
25	12.00	13.06	18.1		54	26.50	27.56	32.6	
26	12.50	13.56	18.6		55	27.00	28.06	33.1	
27	13.00	14.06	19.1		56	27.50	28.56	33.6	
28	13.50	14.56	19.6		57	28.00	29.06	34.1	
29	14.00	15.06	20.1		58	28.50	29.56	34.6	
30	14.50	15.56	20.6		59	29.00	30.06	35.1	
31	15.00	16.06	21.1		60	29.50	30.56	35.6	
32	15.50	16.56	21.6						

技术指标(Technical Index):

- 塑件表面应光洁、无毛边、无明显收缩、缺陷、裂纹等现象。  
(The surface of the plastic parts should be smooth, no rough edges, no obvious shrinkage, defects, cracks and other phenomena.)
- 温度范围(Temperature range): -25° C~+85° C.
- 额定电压(Rated voltage): 50V, AC/DC(=等效).
- 接触电阻(Contact resistance): ≤0.03Ω.
- 绝缘电阻(Insulation resistance): ≥500MΩ.
- 产品料号(Product material No.):

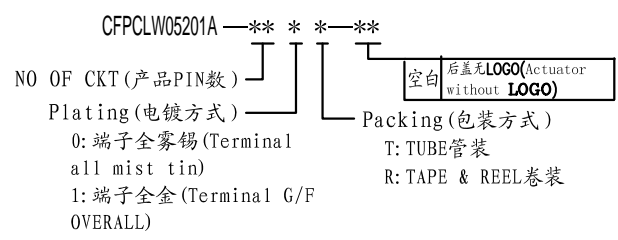

一般公差(TOLERANCE)  
X ±.50 XX ±.10  
X ±.20 XXX ±.05  
ANGLES ±1°

**WFD** CONN 深圳市旺富达电子有限公司  
SHEN ZHEN WFD ELECTRONICS CO., LTD

品名(TITLE) 0.5 Pitch拉拔卧式全上接(H=2.0)  
0.5 Pitch H2.0 ZIF R/A Type 3 Upper SMT CONN.

料号(DWG.NO) CFPCLW05201A-\*\*\*\*\*

比例(SCALE) 1:1 单位(UNITS) mm

制图(DR) Liu Miao  
校对(CHKD) SIMON  
审核(APPD) DAVID

张数(SHEET) 1 OF 1 SIZE REV A4 A