

版次(Edition)	变更摘要(Change The Content)	日期(Date)	序号(NO.)	品名(Name)	材质(Material)
1	增加料号说明(Add Material Number Description)	2020/11/24	①	0.5掀盖胶芯(H=2.0) 0.5 Pitch Easy-on Type Housing (H=2.0)	LCP UL94V-0 本色 <b>Natural</b>
			②	0.5掀盖端子(H=2.0) 0.5 Pitch Easy-on Type Terminal (H=2.0)	磷青铜/表面镀锡 Phosphor Bronze/ Tin Plating
			③	0.5掀盖后盖(H=2.0) 0.5 Pitch Easy-on Type Actuator (H=2.0)	LCP UL94V-0 黑色 <b>Black</b>
			④	0.5掀盖焊片(H=2.0) 0.5 Pitch Easy-on Type Fitting Nail (H=2.0)	黄铜/表面镀锡 Brass/Tin Plating

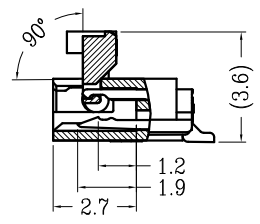

SECTION A-A

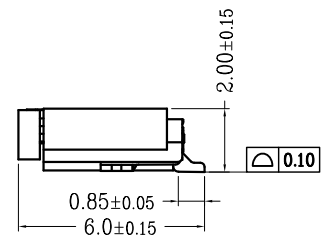
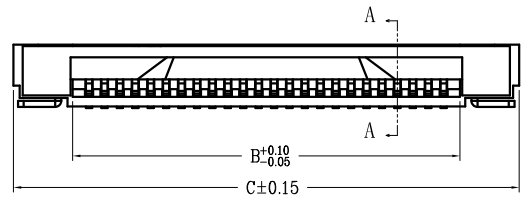
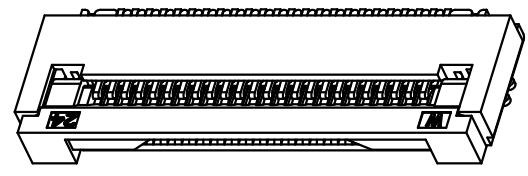
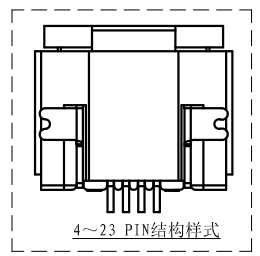
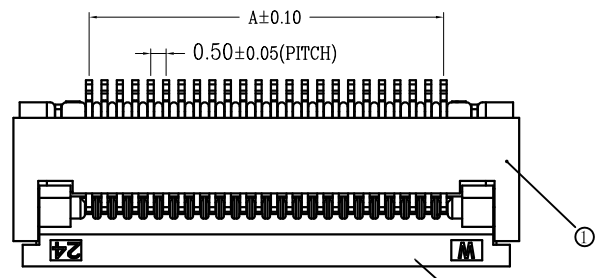
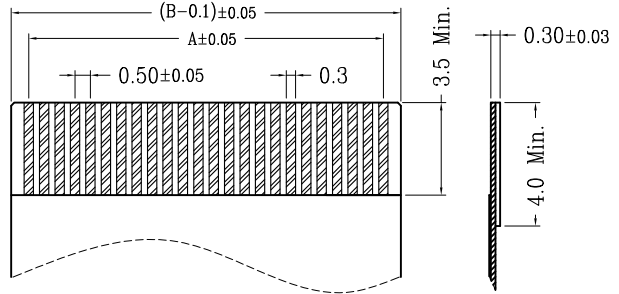
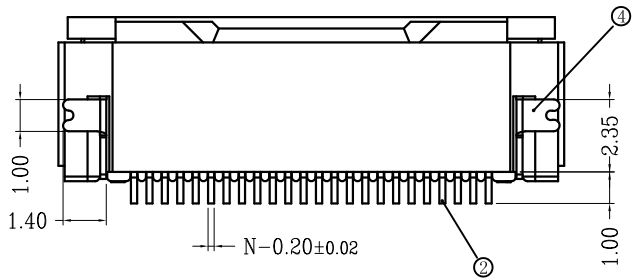

适用扁平线(Applicable Flat Cable)

CKT	A	B	C	CKT	A	B	C
4	1.50	2.56	6.40	34	16.50	17.56	21.40
5	2.00	3.06	6.90	35	17.00	18.06	21.90
6	2.50	3.56	7.40	36	17.50	18.56	22.40
7	3.00	4.06	7.90	37	18.00	19.06	22.90
8	3.50	4.56	8.40	38	18.50	19.56	23.40
9	4.00	5.06	8.90	39	19.00	20.06	23.90
10	4.50	5.56	9.40	40	19.50	20.56	24.40
11	5.00	6.06	9.90	41	20.00	21.06	24.90
12	5.50	6.56	10.40	42	20.50	21.56	25.40
13	6.00	7.06	10.90	43	21.00	22.06	25.90
14	6.50	7.56	11.40	44	21.50	22.56	26.40
15	7.00	8.06	11.90	45	22.00	23.06	26.90
16	7.50	8.56	12.40	46	22.50	23.56	27.40
17	8.00	9.06	12.90	47	23.00	24.06	27.90
18	8.50	9.56	13.40	48	23.50	24.56	28.40
19	9.00	10.06	13.90	49	24.00	25.06	28.90
20	9.50	10.56	14.40	50	24.50	25.56	29.40
21	10.00	11.06	14.90	51	25.00	26.06	29.90
22	10.50	11.56	15.40	52	25.50	26.56	30.40
23	11.00	12.06	15.90	53	26.00	27.06	30.90
24	11.50	12.56	16.40	54	26.50	27.56	31.40
25	12.00	13.06	16.90	55	27.00	28.06	31.90
26	12.50	13.56	17.40	56	27.50	28.56	32.40
27	13.00	14.06	17.90	57	28.00	29.06	32.90
28	13.50	14.56	18.40	58	28.50	29.56	33.40
29	14.00	15.06	18.90	59	29.00	30.06	33.90
30	14.50	15.56	19.40	60	29.50	30.56	34.40
31	15.00	16.06	19.90	61	30.00	31.06	34.90
32	15.50	16.56	20.40	64	31.50	32.56	36.40
33	16.00	17.06	20.90	65	32.00	33.06	36.90

技术指标(Technical Index):

- 塑件表面应光洁、无毛边、无明显收缩、缺陷、裂纹等现象。(The surface of the plastic parts should be smooth, no rough edges, no obvious shrinkage, defects, cracks and other phenomena.)
- 温度范围(Temperature range): -25° C~85° C.
- 额定电压(Rated voltage): 50V, AC/DC(=等效).
- 接触电阻(Contact resistance): ≤0.03Ω.
- 绝缘电阻(Insulation resistance): ≥500MΩ.
- 产品料号(Product material No.):

CFPCXW05202A-\*\*-\*\*

NO OF CKT (产品PIN数)

Plating (电镀方式)

0: 端子全雾锡(Terminal all mist tin)

1: 端子全金(Terminal G/F OVERALL)

后盖无LOGO(Actuator without LOGO)

Packing (包装方式)

T: TUBB管装

R: TAPE & REEL卷装

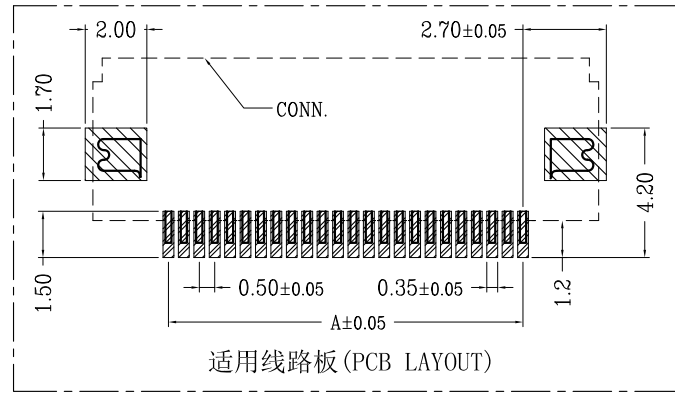

适用线路板(PCB LAYOUT)



一般公差(TOLERANCE)  
X ±0.50 XX ±1.0  
X ±0.20 XXX ±0.05  
ANGLES ±1°

**WFD** CONN 深圳市旺富达电子有限公司  
SHEN ZHEN WFD ELECTRONICS CO., LTD

品名(TITLE) 0.5 Pitch掀盖卧式下接(H=2.0)  
0.5 Pitch H2.0 Easy-on R/A Lower Type SMT CONN.

料号(DWG.NO) CFPCXW05202A-\*\*-\*\*

比例(SCALE) 1:1 单位(UNITS) mm

制图(DR) Liu Miao  
校对(CHKD) SIMON  
审核(APPD) DAVID

张数(SHEET) 1 OF 1 SIZE A4 REV A