

版次 (Edition)	变更摘要 (Change The Content)	日期 (Date)	序号 (NO.)	品名 (Name)	材质 (Material)
1	增加料号说明 (Add Material Number Description)	2020/11/24	①	0.5掀盖胶芯 (H=1.5) 0.5 Pitch Easy-on Type Housing (H=1.5)	LCP UL94V-0 本色 Natural
			②	0.5掀盖端子 (H=1.5) 0.5 Pitch Easy-on Type Terminal (H=1.5)	磷青铜/表面镀锡 Phosphor Bronze/ Tin Plating
			③	0.5掀盖后盖 (H=1.5) 0.5 Pitch Easy-on Type Actuator (H=1.5)	LCP UL94V-0 黑色 Black
			④	0.5掀盖焊片 (H=1.5) 0.5 Pitch Easy-on Type Fitting Nail (H=1.5)	磷青铜/表面镀锡 Phosphor Bronze/ Tin Plating

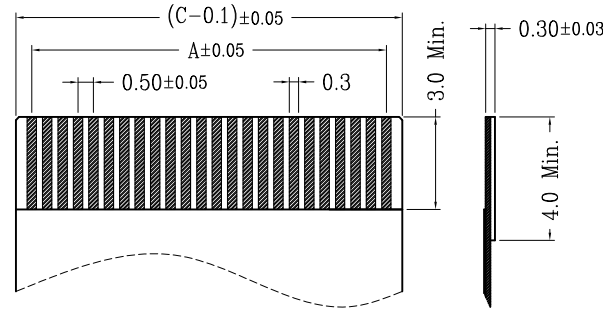
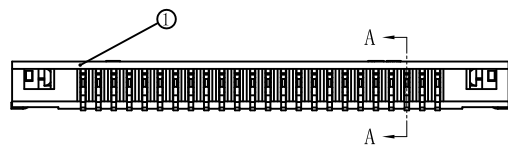
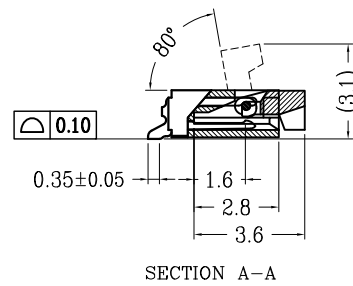
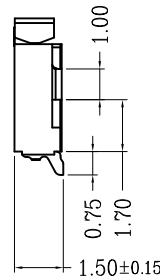
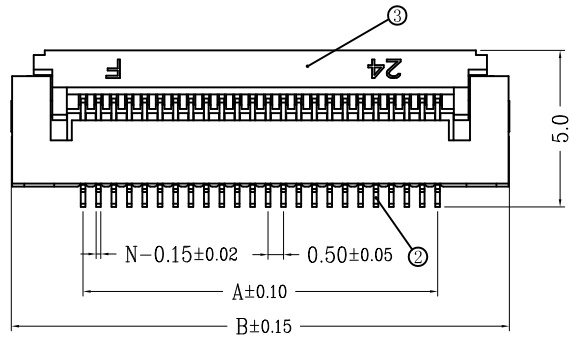
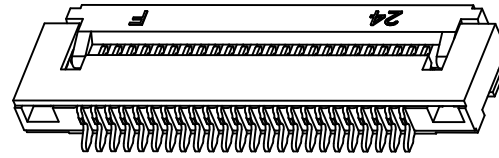
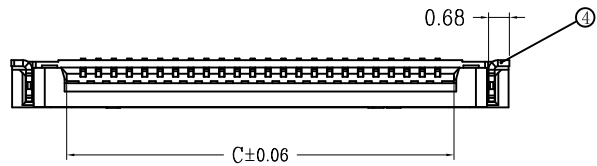

CKT	A	B	C	CKT	A	B	C
4	1.50	6.15	2.56	33	16.00	20.65	17.06
5	2.00	6.65	3.06	34	16.50	21.15	17.56
6	2.50	7.15	3.56	35	17.00	21.65	18.06
7	3.00	7.65	4.06	36	17.50	22.15	18.56
8	3.50	8.15	4.56	37	18.00	22.65	19.06
9	4.00	8.65	5.06	38	18.50	23.15	19.56
10	4.50	9.15	5.56	39	19.00	23.65	20.06
11	5.00	9.65	6.06	40	19.50	24.15	20.56
12	5.50	10.15	6.56	41	20.00	24.65	21.06
13	6.00	10.65	7.06	42	20.50	25.15	21.56
14	6.50	11.15	7.56	43	21.00	25.65	22.06
15	7.00	11.65	8.06	44	21.50	26.15	22.56
16	7.50	12.15	8.56	45	22.00	26.65	23.06
17	8.00	12.65	9.06	46	22.50	27.15	23.56
18	8.50	13.15	9.56	47	23.00	27.65	24.06
19	9.00	13.65	10.06	48	23.50	28.15	24.56
20	9.50	14.15	10.56	49	24.00	28.65	25.06
21	10.00	14.65	11.06	50	24.50	29.15	25.56
22	10.50	15.15	11.56	51	25.00	29.65	26.06
23	11.00	15.65	12.06	52	25.50	30.15	26.56
24	11.50	16.15	12.56	53	26.00	30.65	27.06
25	12.00	16.65	13.06	54	26.50	31.15	27.56
26	12.50	17.15	13.56	55	27.00	31.65	28.06
27	13.00	17.65	14.06	56	27.50	32.15	28.56
28	13.50	18.15	14.56	57	28.00	32.65	29.06
29	14.00	18.65	15.06	58	28.50	33.15	29.56
30	14.50	19.15	15.56	59	29.00	33.65	30.06
31	15.00	19.65	16.06	60	29.50	34.15	30.56
32	15.50	20.15	16.56				

技术指标:

1. 塑件表面应光洁、无毛边、无明显收缩、缺陷、裂纹等现象。
2. 温度范围: -25° C~+85° C.
3. 额定电压: 50V, AC/DC(等效).
4. 接触电阻: ≤0.03Ω.
5. 绝缘电阻: ≥500MΩ
6. 产品料号:

CFPCHW05152A-**-**

NO OF CKT (产品PIN数)

Plating (电镀方式)

0: 端子全雾锡

1: 端子全金 (G/F OVERALL)

5: 端子半金锡

Packing (包装方式)

T: TUBE管装

R: TAPE & REEL卷装

后盖无LOGO (Actuator without LOGO)

空白

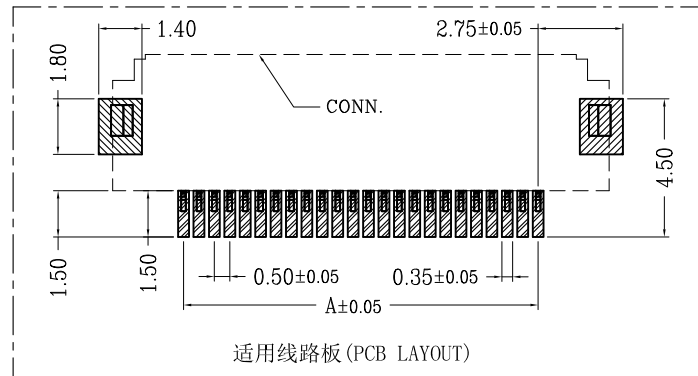

适用线路板 (PCB LAYOUT)

适用扁平线 (Applicable Flat Cable)



一般公差 (TOLERANCE)
X ±0.50 .XX ±10
X ±0.20 .XXX ±05
ANGLES ±1°

WFD 深圳市旺富达电子有限公司
CONN SHEN ZHEN WFD ELECTRONICS CO., LTD

品名 (TITLE)	0.5 Pitch掀盖卧式下接 (H=1.5) 0.5 Pitch H1.5 Easy-on R/A Lower Type SMT CONN.	制图 (DR)	Liu Miao
图号 (DWG.NO)	CFPCHW05152A-**-**	校对 (CHKD)	SIMON
比例 (SCALE)	1:1	审核 (APPD)	DAVID
单位 (UNITS)	mm	张数 (SHEET)	1 OF 1
		SIZE	A4
		REV	A