



SPECIFICATIONS

Rated Current:1.0AMP
 Contact Resistance:20mΩ Max
 Withstand Voltage:500V AC/DC
 Insulation Resistance:1000MΩ Min
 Operation Temperature:-40°c to +105°c

Contact Material:Phosphor Bronze
 Contact Plating:Au or Sn Over Ni
 Insulator Material:Polyester(UL94V-0)
 Standard: PA6T
 Max.Processing Temp: 230°C for 30-60 seconds
 (260°C for 10 seconds)

Recommended P.C.B Layout(Top Side)
 (PCB BOARD TOLERANCE±0.05)

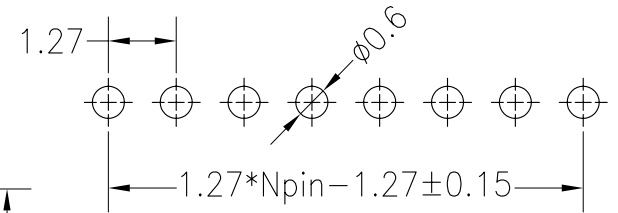
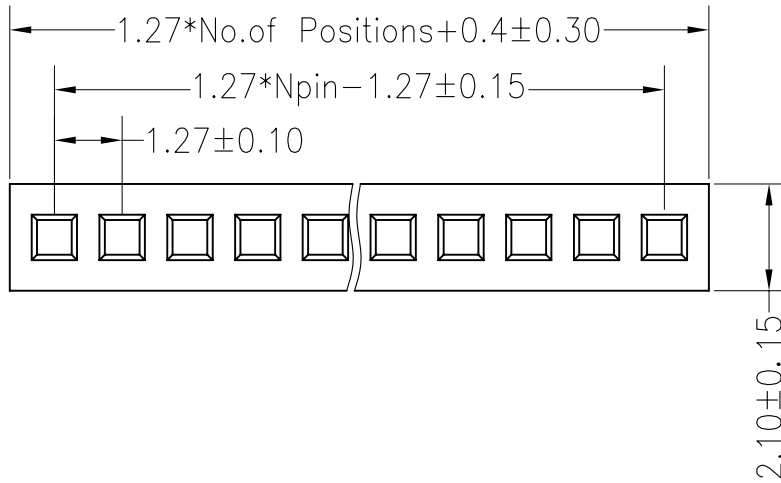

Ordering Information

2420 -01 XX X N XX S U X 01

No.of Pins Per Row 1*50

Insulator Material Option
 A=BK-PBT
 B=BK-PA66
 C=BK-PA6T
 D=BK-PA46
 F=BK-LCP

Contact Plating
 G0:Gold Flash
 G2:5U" Gold
 G3:10U" Gold
 G4:15U" Gold
 G5:30U" Gold
 S0:Gold Flash/Tin
 SN:Tin

Packing
 T=Tube
 P=Tube+Cap
 R=Reel+Cap
 M=Reel+Mylar

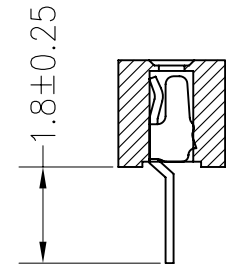
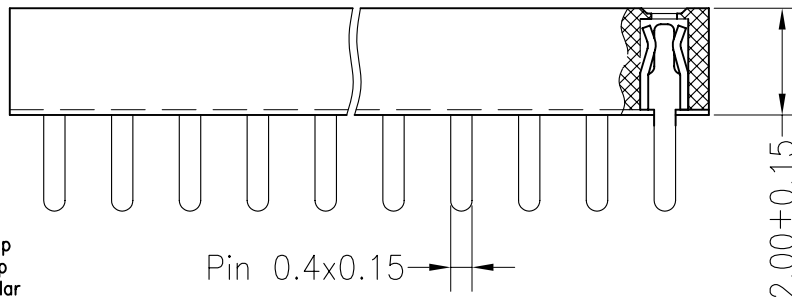

				OPERATION		DRAW	Liu Miao	15.01.28	SCALE	FIT	WFD CONN 深圳市旺富达电子有限公司 SHEN ZHEN WFD ELECTRONICS CO., LTD	
				X.X	±0.30				UNIT	mm		
				CHECK				SIZE	A4	PART NO. 242001XXXNXXSUX01 TITLE: 1.27PF H2.00mm 1xNpin 180°		
				APPROVE				SHEET	1/1			
REV	DATE	MODIFICATION DESCRIPTION	CHANGE	DIM	TOL	PROJ.						